

## Daily Care of your Voice Prosthesis

### Provox® Brush



To help improve performance and prolong device life, clean your voice prosthesis in the morning, evening and after each meal using the Provox Brush and the Provox Flush.

1. Moisten the bristles of the Provox Brush with drinking water and then insert all the way through the voice prosthesis. Gently pull back on the Brush if you feel any resistance.
2. Gently move the Brush back and forth while rotating the Brush at the same time; this will clean the whole prosthesis. Continue in this way until the Brush comes out clean and is free of any debris from your prosthesis.
3. When you are finished:
  - Clean the Brush with drinking water and dish soap.
  - Rinse with drinking water and allow to air dry before storing.
4. Replace the Brush once a month or sooner if the bristles become worn or discolored.

**Tip:** If needed, the blue shaft of the Brush can be bent for better access to the voice prosthesis. Do not bend the wire head of the Brush. Do not rotate the Brush during cleaning when the shaft is bent.

**Tip:** If your prosthesis is 12.5 mm or longer, use a Provox Brush XL. If your prosthesis is 10 mm or shorter, use a regular Provox Brush.

5. Disinfect the Provox Brush according to the Provox Brush manual.

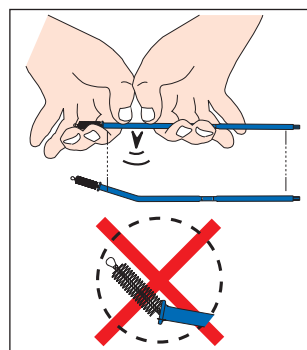
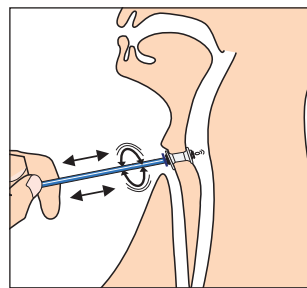

## Daily Care of your Voice Prosthesis

### Provox® Flush



To help improve performance and prolong device life, clean your voice prosthesis in the morning, evening and after each meal using the Provox Brush and the Provox Flush.

1. Use the Provox Flush with drinking water or air. Do not use with any liquid other than water.

**Tip:** If you want to use the Flush with water, practice with air first. Continue with water when you feel confident. **Warning: avoid getting water in trachea**

2. Place the pointed end of the Flush into a glass of drinking water. Squeeze and release the clear silicone bulb to fill the suction bulb with water.
3. Insert the pointed end of the Provox Flush completely into the voice prosthesis ensuring it is sealed off properly. The Flush can be bent for better access to the voice prosthesis.
4. Gently squeeze the water into the prosthesis.
5. Tilt the bulb upwards and release your squeeze on the bulb. The bulb will reinflate. Remove the Flush from the voice prosthesis.

**Tip:** If using water, tilting the bulb upwards as you release your squeeze on the bulb will allow any water to return into the suction bulb. Avoid dripping water into the airway as this may cause coughing.

6. To clean the Flush, remove the bulb from the insertion shaft and clean both parts with drinking water and dish soap to remove any debris. Allow to air dry before storing.
7. Disinfect the Flush at least once daily according to the Provox Flush manual.
8. Replace the Provox Flush at least once every 12 months.

